

FS-CLKSP insert

compatible with Clank! In! Space![®]
incl. the Cyber Station 11[®] and Apocalypse[®] expansions

Assembly Instructions

The package contains 6 sheets, three of them are identical to the other three.

The parts marked in sheet C2 are to be discarded.

After assembly the trays are put in two layers in the original game box.

Ordinary PVA glue is required when assembling each tray.

Please make sure you dry-assemble each tray correctly before gluing it together.

Please check www.foldedspace.net for general assembly tips.

FS-CLKSP

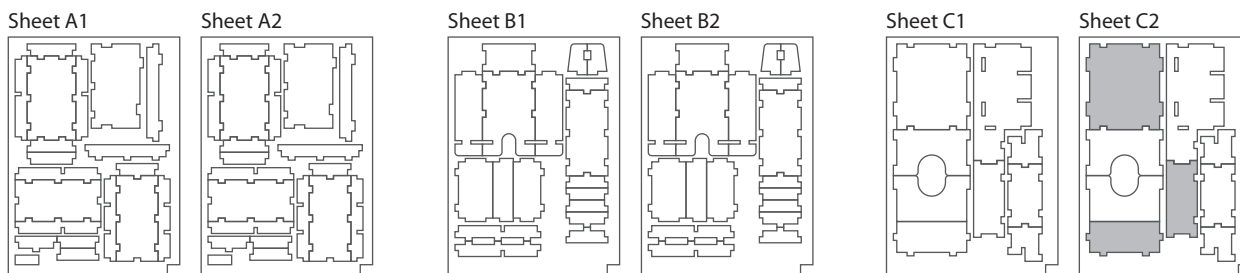
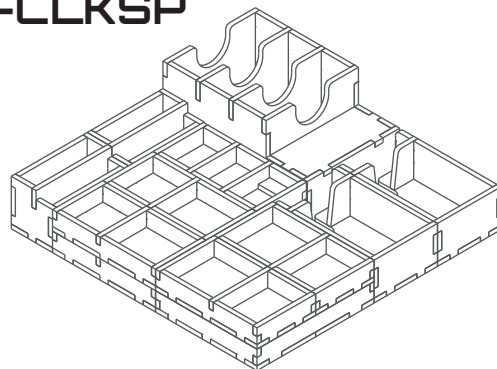

Tray 1a & 1b (the trays are identical)

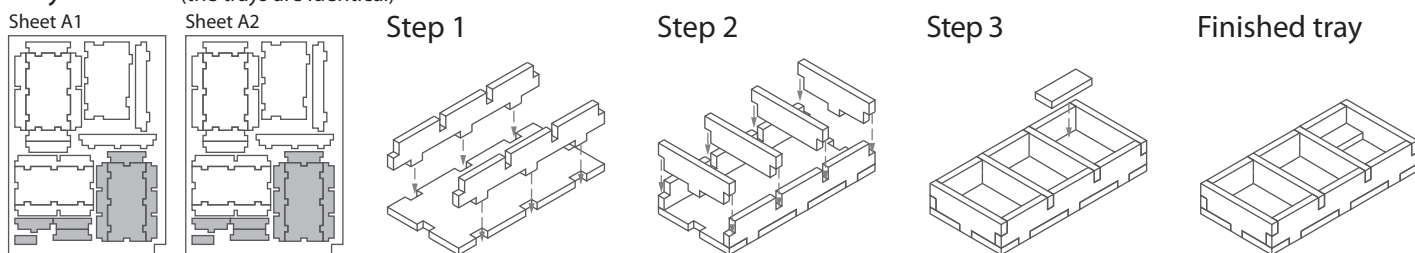

Tray 2a, 2b, 2c & 2d (the trays are identical)

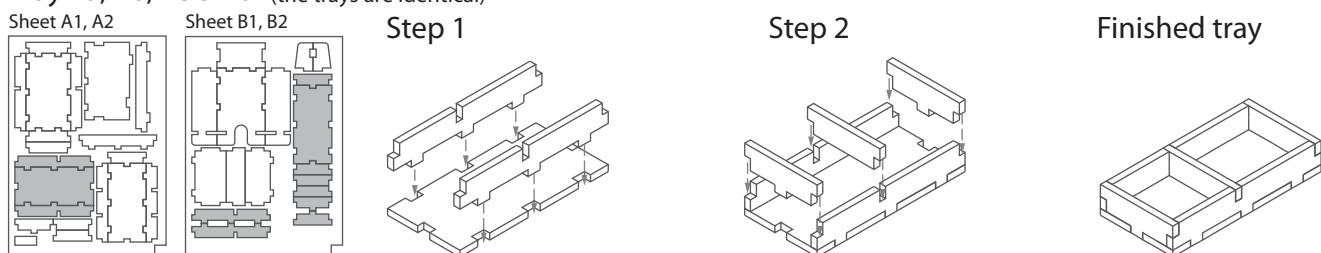

Tray 3a & 3b (the trays are identical)

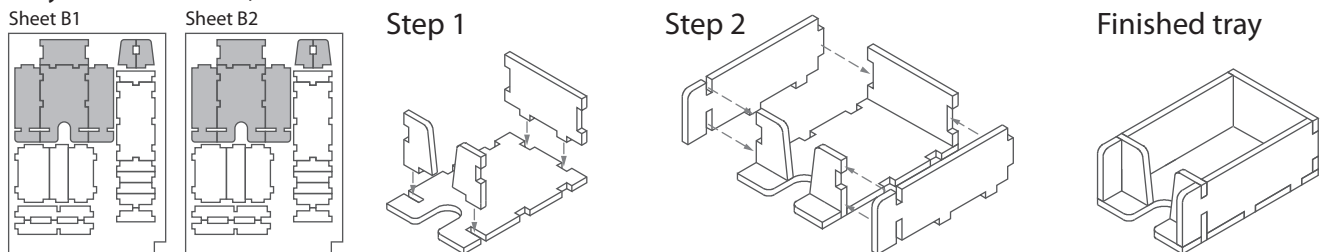

Tray 4a & 4b (the trays are identical)

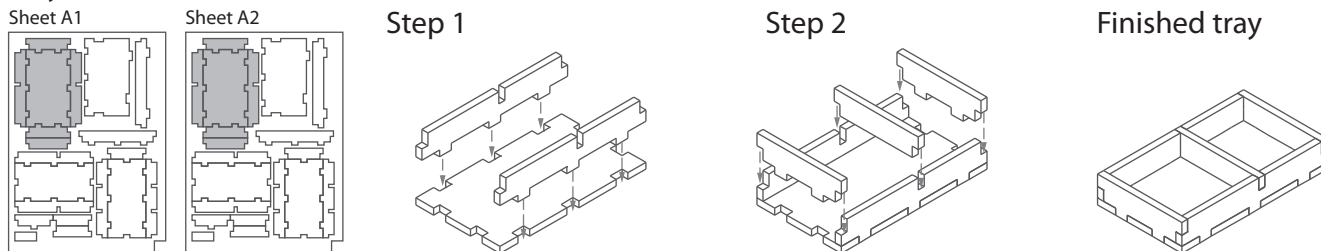

FS-CLKSP insert compatible with Clank! In! Space!®

incl. the Cyber Station 11® and Apocalypse® expansions



Tray 5

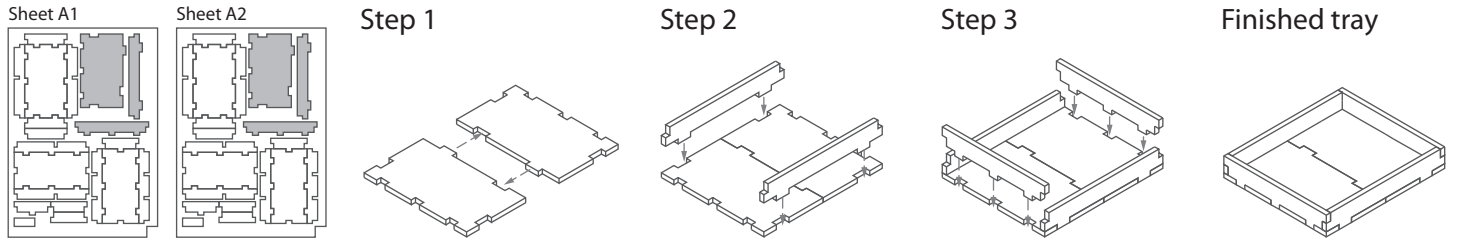

Tray 6a & 6b (the trays are identical)

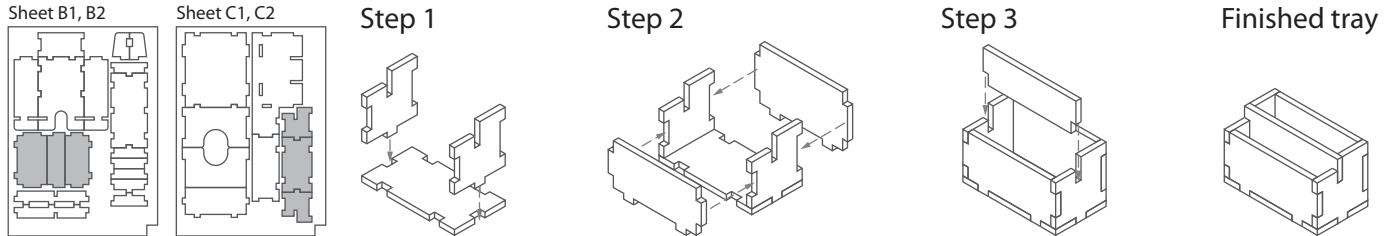

Tray 7

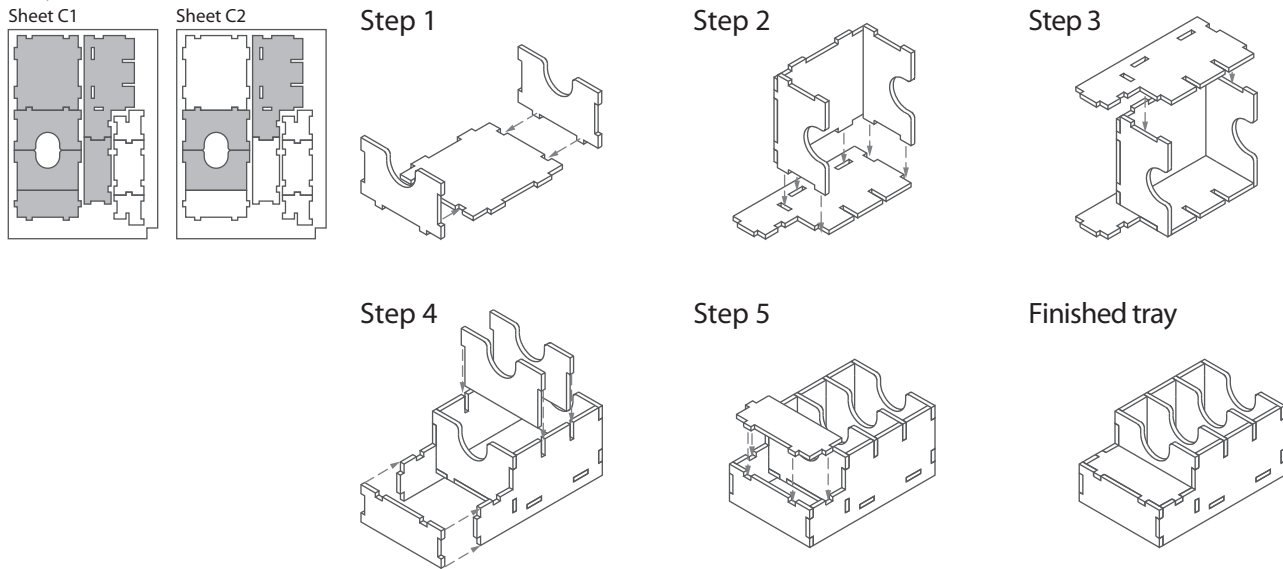

FS-CLKSP

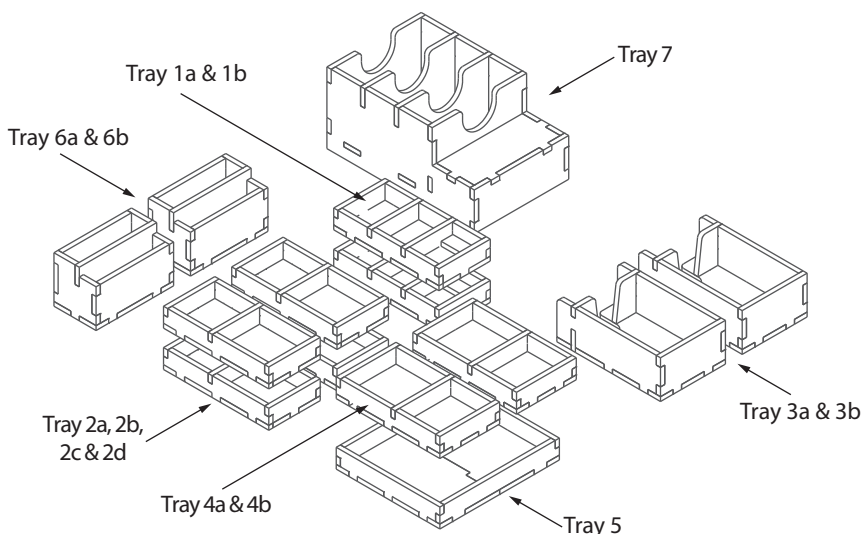

Please check www.foldedspace.net for photos of this insert in use.

Tray legend:

- Tray 1a - power crystals, market items, and artifact tokens
- Tray 1b - boss cubes, blockade and escape pod tokens
- Tray 2a, b, c, d - player pieces
- Tray 3a - starting deck cards
- Tray 3b - reserve cards
- Tray 4a - minor and major secret tokens
- Tray 4b - credit tokens
- Tray 5 - scheme cards and boss markers
- Tray 6a, b - filler trays to hold boards in place
- Tray 7 - adventure deck cards

Note: this game has many varied boards, please check www.foldedspace.net to see how best to place them in the box.

Tip: Keep the instructions in the bottom of your board game box as a reminder of how the insert fits together.